

Get started with myAbilia and CARY Base

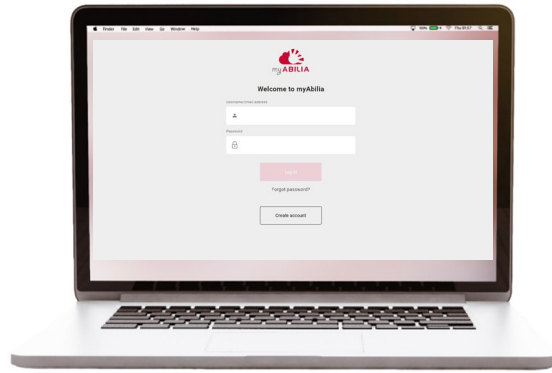

Get started with myAbilia – step by step

1. Set up myAbilia account



- a) Go to www.myabilia.com on a computer, mobile phone or tablet.
- b) Create a user account on myAbilia.
- c) Log in to myAbilia.
- d) **Select the calendar module CARY.**
- e) **Import the image library CARY.**

2. Connect CARY Base to myAbilia

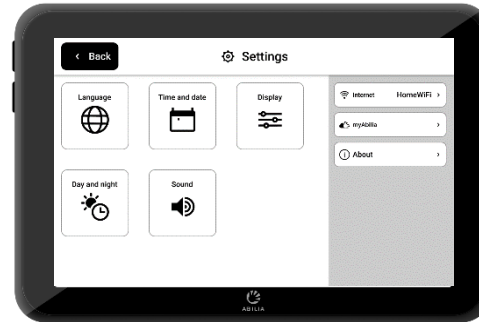

Make sure that the device is connected to Wi-Fi and log in with the user account.

3. Add activities

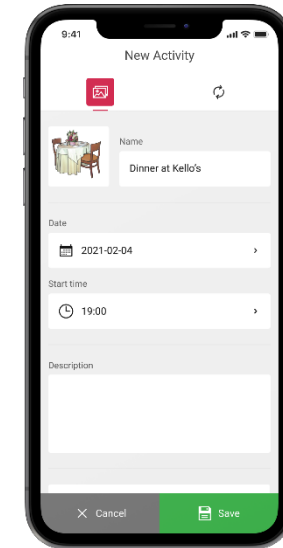

Log in to www.myabilia.com on a computer, mobile phone or tablet.

Use myAbilia to manage the calendar in CARY Base.

If you need more help, follow the instructions in this guide!

Create a user account at myAbilia



1. Open a web browser and go to www.myabilia.com.
2. Select **Create account**.
3. Select account type **User** and follow the instructions.

www.myabilia.com



Welcome to myAbilia

Username/Email address

Password

Log in

Forgot password?

Create account

A teal-colored oval is drawn around the 'Create account' button, which is a white rectangular button with a thin black border, located at the bottom of the login form.

Log in to myAbilia

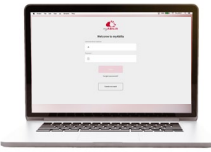

1. Open a web browser and go to www.myabilia.com.
2. Enter your username and password and select **Log in**.

The image illustrates the login process for myAbilia. On the left, the web login page is shown with the myABILIA logo, a 'Welcome to myAbilia' message, and a login form. The form includes a 'Username/Email address' field with 'anna@gmail.com' and a 'Password' field with masked characters. A red 'Log in' button is highlighted, with an arrow pointing to the mobile app interface on the right. The mobile app interface shows a user profile for 'Anna' at the top, a 'New' button, and a calendar view for 'Week 33' from Monday 16 to Sunday 22. A dark sidebar menu is open, listing various features: Calendar, Basic Activities, Basic Timers, Checklist, Image Archive, Notes, and Voice Note.

Select the calendar module CARY



1. Select  and **My Profile** in the menu.
2. Select the tab **Modules** and select the modules intended for CARY:
 - Calendar – CARY
 - Basic Activities
 - Image Archive
3. Select **Save**.

The screenshot shows the user profile settings for 'Anna'. The 'Modules' tab is selected, and a list of modules is displayed. The 'Calendar' module is checked, and the 'CARY' option under it is also checked. Other modules like 'Basic Activities', 'Image Archive', and 'MEMOplanner' are also visible. A blue circle highlights the 'Calendar' and 'CARY' options. At the bottom, there are 'Cancel' and 'Save' buttons.

Module	Selected
Calendar	Yes
MEMOplanner	No
HandiCalendar	No
CARY	Yes
Basic Activities	Yes
Basic Timers	No
Checklist	No
Image Archive	Yes
Notes	No
Voice Note	No
GEWA	No

Import the image archive CARY



1. Select  and **Image Archive** in the menu.
2. Select **New** and **Import from Image Library**.
3. Select image archive **CARY** and **Add**.

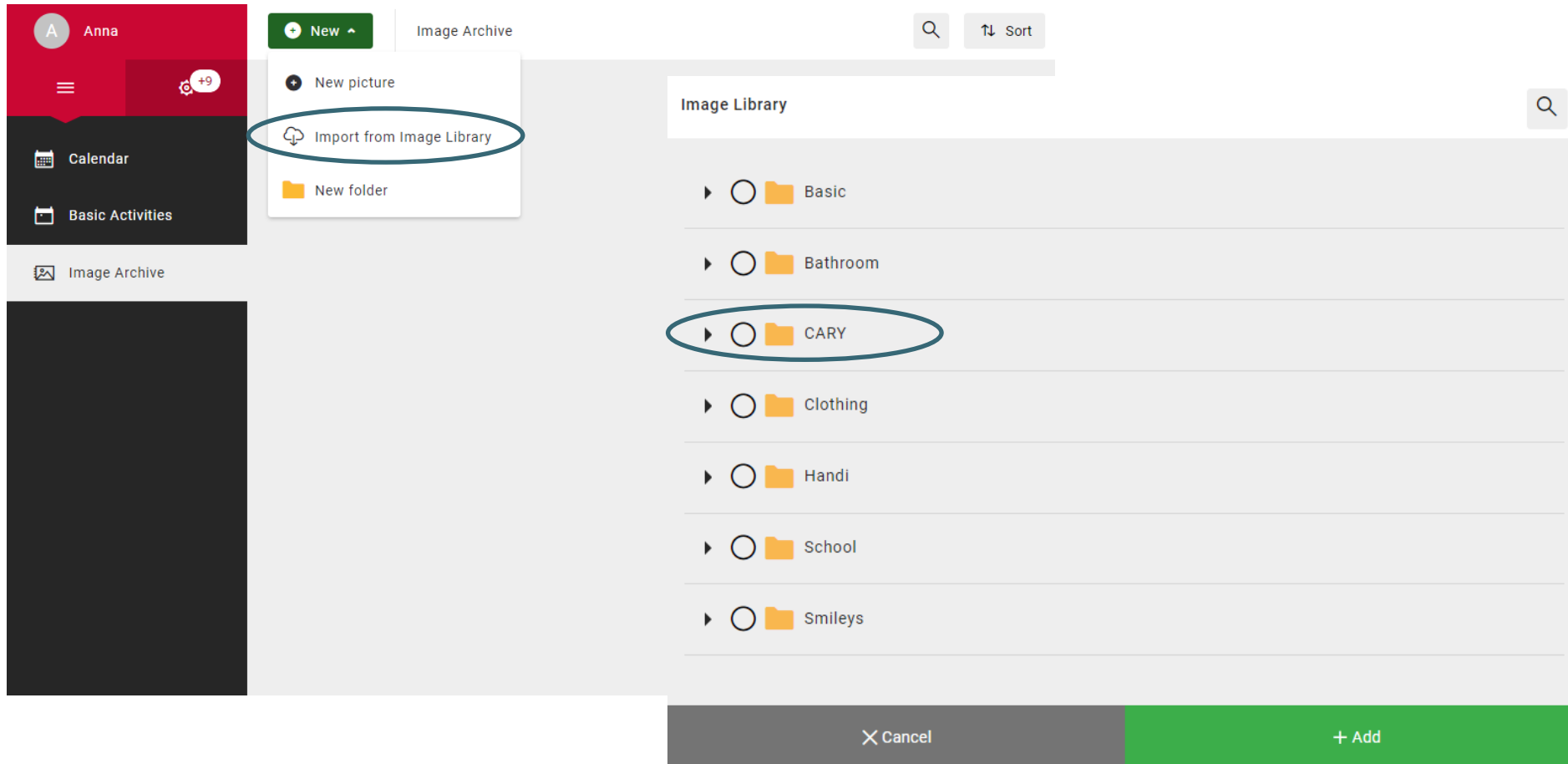

Connect CARY Base to myAbilia



1. Go to the Power menu and select **Settings**.

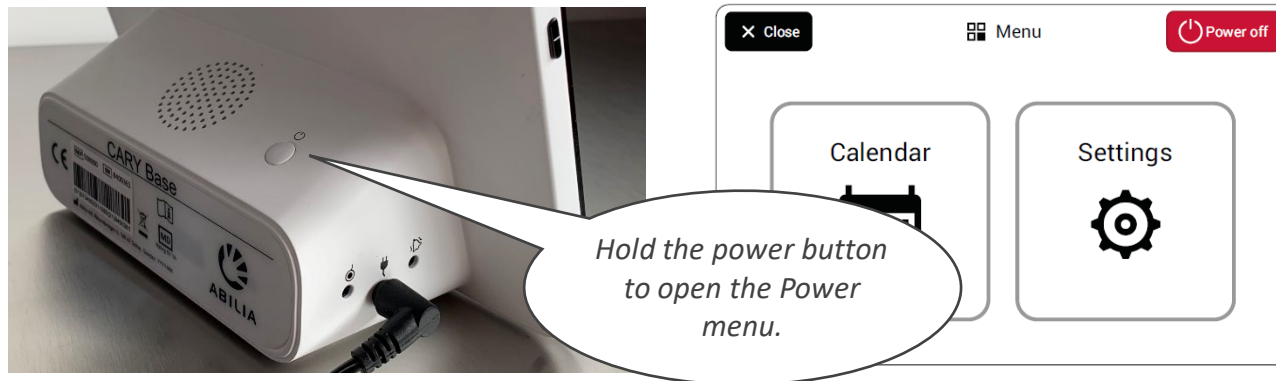

2. If the unit is not connected to the Internet, select **Internet** and select an available wireless network (Wi-Fi).
3. Select **myAbilia**.
4. Enter your username and password and select **Log in**.
5. Select **Back** and then **Close** to get back to the main view.

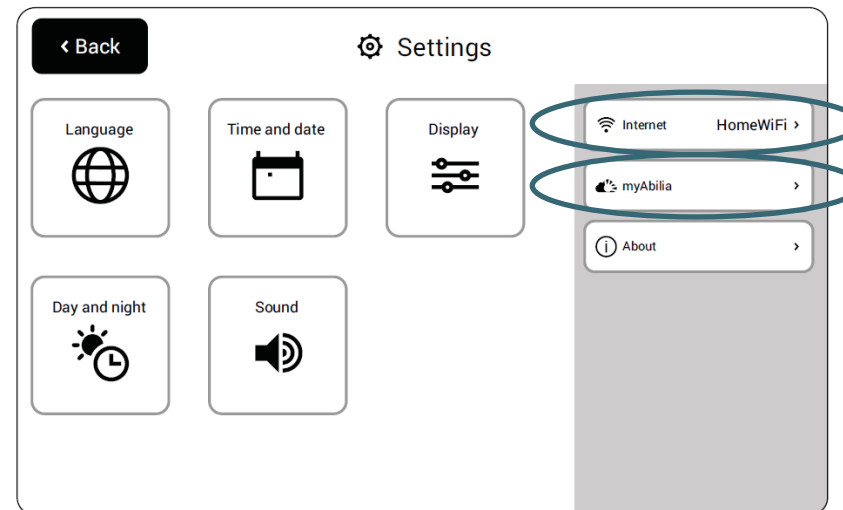

Add activities

1. Log in to www.myabilia.com with your user account.
2. Tap directly in the calendar to select **Date** and **Start time** of the activity.
3. Enter the name of the activity in the **Name** field.
4. Add a **Picture** and **Description** to the activity (optional).
5. Select to play a **message** or **text** when the reminder is shown (optional).
6. Select **Create** to save the activity.



CARY New Activity

Name & Picture **Recurrence**

Picture: 

Name: Walk the dog

Date: 2023-02-09

Description: Don't forget dog poop bags

Start time: 15:30

Record message

Extra settings: Show in dayplan Play text at alarm

Cancel **Create**

Message =
Recorded sound or reading of text (Name and Description)

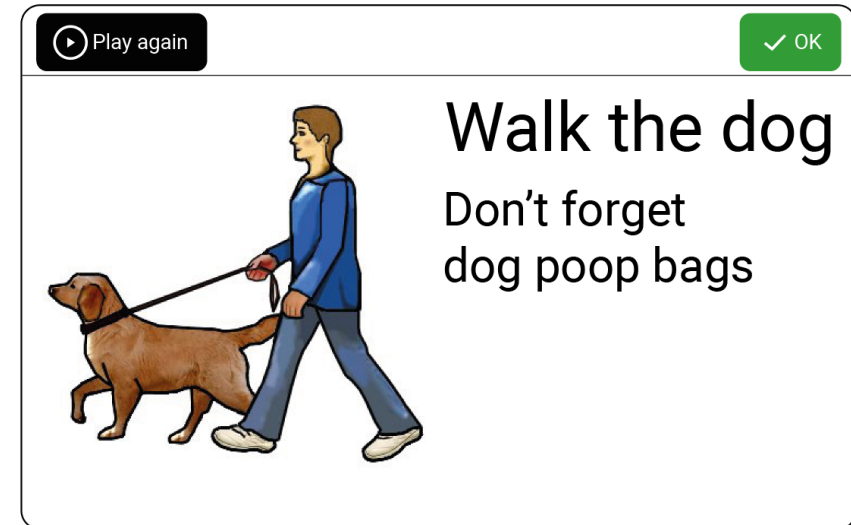

Name

Description

Picture =
Picture from the image archive or your own photo.

How myAbilia works

Add an activity in CARY Base through myAbilia

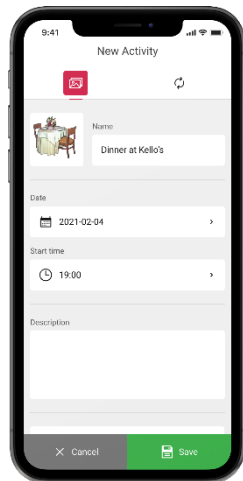

The activity shows in CARY Base



CARY Base is updated:
- Every five minutes
- When you tap Calendar